

DO NOT SCALE

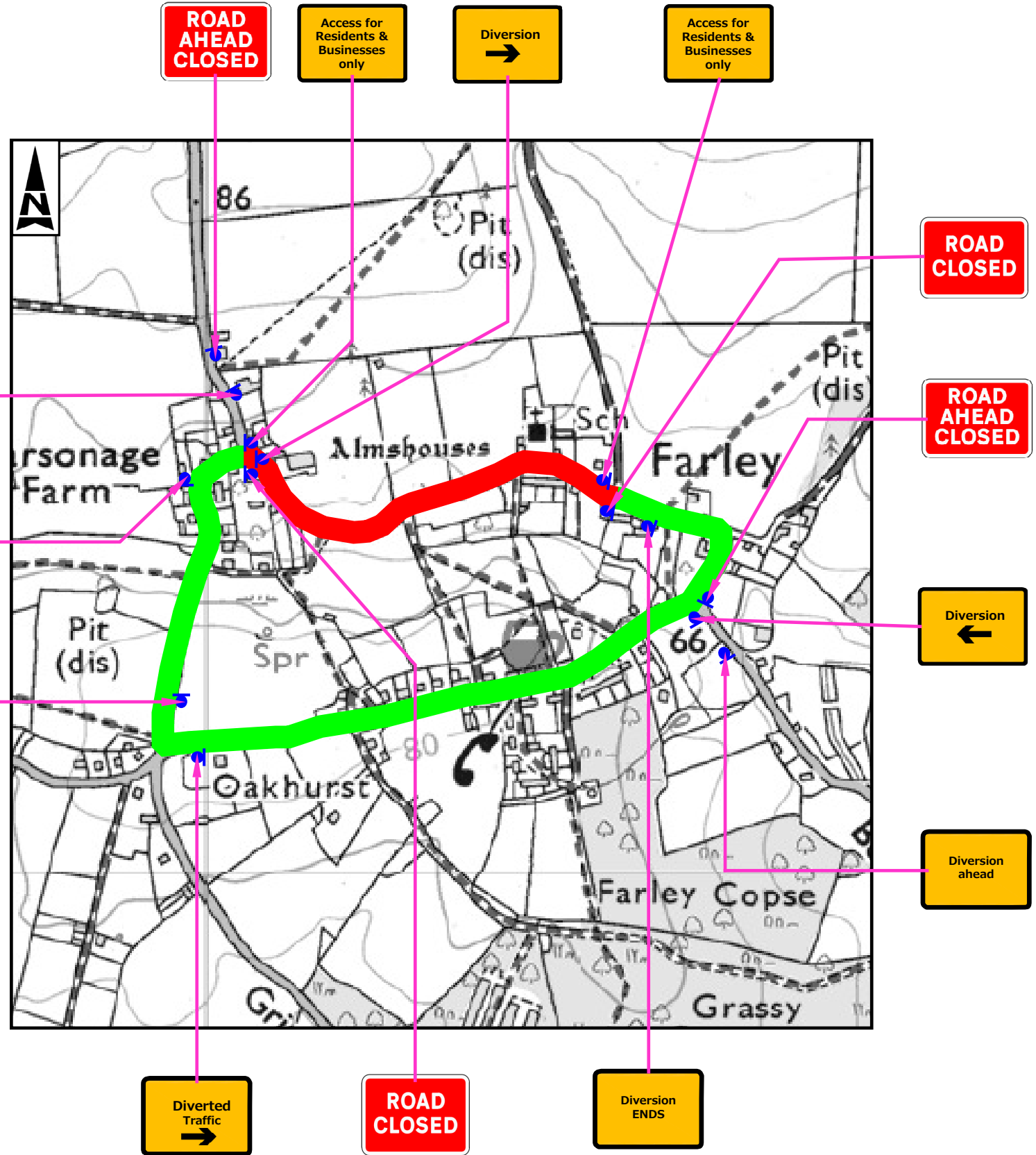

SIGN SCHEDULE

Letters/Borders-White Background-Red X-height-100mm 2 No.required	Letters/Borders-White Background-Red X-height-100mm 2 No.required
Letters/Borders-Black Background-Yellow X-height-75mm 1 No.required	Letters/Borders-Black Background-Yellow X-height-75mm 1 No.required
Letters/Borders-Black Background-Yellow X-height-75mm 1 No.required	Letters/Borders-Black Background-Yellow X-height-75mm 1 No.required
Letters/Borders-Black Background-Yellow X-height-75mm 2 No.required	Letters/Borders-Black Background-Yellow X-height-75mm 2 No.required
Letters/Borders-Black Background-Yellow X-height-75mm 2 No.required	

- Notes**
- Limits of Work & dimensions are approx. and are to be agreed on site with the Engineer.
 - All 'Road Closed' signs to be accompanied by barrier & cones to create a physical staggered barrier across the carriageway to deter motorists from entering the site.
 - All signs with a white border and red background have a 100mm x-height.
 - All signs with a black border and yellow background have a 75mm x-height.
 - All signs to be supplied in 1050mm X750mm portable frames and secured with sandbags, unless stated otherwise.
 - All sign faces to be to BS EN 12899-1:2007 Class RA2.
 - Road Closure to be removed outside of operational hours.

- Key**
- Road Closed
 - Proposed Diversion Route
 - Gatemanager Positions
 - Direction which the sign faces traffic

WC Briefs No: 02-15-02
 Client Finance Code: 632338
 Works Order No: TBA
 Postal Area: SP5
 OS Grid Ref: 442050,129559 to 422538,129505
 Philips Street Atlas: P154-E8
 Road Speed Limit: 30 mph
 USRN : 33500984

SAFETY, HEALTH AND ENVIRONMENTAL INFORMATION	
IN ADDITION TO THE HAZARDS/RISKS NORMALLY ASSOCIATED WITH THE TYPES OF WORK DETAILED ON THIS DRAWING, NOTE THE FOLLOWING SIGNIFICANT RESIDUAL RISKS	
CONSTRUCTION	NONE
MAINTENANCE/CLEANING	NONE
USE	NONE
DECOMMISSIONING/DEMOLITION	NONE

THIS MAP IS REPRODUCED FROM ORDNANCE SURVEY MATERIAL WITH THE PERMISSION OF ORDNANCE SURVEY ON BEHALF OF THE CONTROLLER OF HER MAJESTY'S STATIONERY OFFICE. © CROWN COPYRIGHT. UNAUTHORISED REPRODUCTION IN FRINGES CROWN COPYRIGHT AND MAY LEAD TO PROSECUTION OR CIVIL PROCEEDINGS. 100049050, 2014

Stat	Purpose of Issue	Date	Auth	Rev	Description	By	Date	Chk'd	Auth
A	Issued for Construction	02/11/17	DT	C1	First Issue	VT	02/11/17	TMck	DT

ATKINSTM
 Atkins Limited
 Consulting Engineers,
 County Gate, County Way
 Trowbridge, Wiltshire
 BA14 7FJ
 Tel: 01225 730360
 www.atkinsglobal.com

Client **Wiltshire Council**
 Where everybody matters

Project
**Surface Treatment Schemes 2017/2018
 Reactive Maintenance Schemes**

Title Church Road, Farley Diversion Signing & Schedule	
A1	Original Scale N.T.S
S2	Designed/Drawn VT Date 02/11/17
	Checked TMck Date 02/11/17
	Authorised DT Date 02/11/17
Status S2	Drawing Number 5157944-ATK-DR-C-328714-003
	Rev C1